

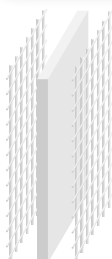

55% Recycled polypropylene

Food-grade polypropylene

Polyester



Filter media material and porosity engraved on flange.

### Product made from recycled materials



SIEBEC  
SUSTAINABLE  
PROGRAM

This product is part of our eco-friendly program (SIEBEC CSR), reflecting our commitment to environmental sustainability.

Incorporating PIR recycled plastic, it helps reduce our carbon footprint by nearly 100 tons per year while supporting a circular economy approach.

Made in France and designed with locally recycled materials.

### Features & Benefits

- Wide range of porosity from 1µm to 200µm, filter materials and media
- 100% welded and reinforced design
- High retention capacity thanks to its design (draining grids, multi-layers, etc.)
- Low pressure losses
- Contains no surfactants, binders, adhesives or silicone
- Compatible with most pocket housings on the market
- Filter media type and porosity engraved on flange for precise identification.
- Filter surface multiplied by 4.5 compared with a bag of the same size

### Standard dimensions

Lip seal outside diameter	180 mm
External diameter external cage	152 mm
Internal diameter	72 mm
Length	Size 10 and 20 pocket equivalent

### Description

QUALI-PLEATED-BAG-FELT products are pleated filter elements of the nominal filtration type that fit in place of a filter bag.

The large filter surface area combined with the high porosity felt media provide the QUALI-PLEATED-BAG-FELT with minimal pressure drop and excellent retention capabilities.

QUALI-PLEATED-BAG-FELT is assembled by heat welding to ensure maximum chemical compatibility and avoid the risk of contamination. Pressure and temperature resistance is enhanced by the injection moulded outer cage. Unlike existing technologies, this design gives the pleated filter bag greater rigidity and drastically increases the filtration area compared with conventional filter bags.

Consequently, once the 'QUALI-PLEATED-BAG-FELT' becomes blocked, it can be removed without difficulty.

QUALI-PLEATED-BAG-FELT incorporates a mesh spacer upstream and downstream of the filter media to ensure the pleats are spaced apart. This design increases filter life and maximises filtration throughput.

### Materials of construction

Code	Material	Max. operating temperature	Application
QTPR	Recycled polypropylene	70°C	Reducing carbon impact
QTP	Food-grade polypropylene	70°C	FDA food application
QTPE	Polyester	110°C	High temperature and solvent

### Range of filter media available

Code	Material	Description
P0	Polypropylene felt	Standard version with maximum filter surface - FDA-compliant food-grade
POT	Thick polypropylene felt	Thicker configuration for longer service life - FDA-compliant food-grade
PEF	Polyester felt	Standard version with maximum filter surface - FDA-compliant food-grade
PEFT	Thick polyester felt	Thicker configuration for longer service life - FDA-compliant food-grade

### Terms of service

Maximum pressure loss	3 bar
Recommended replacement pressure differential	2 bar

## ORDER REFERENCE

Example :

A B C D E  
QTPR - P - P0 - 5 - 20 - 0 - N

### A / Materials of construction

Code	Description
QTPR	Recycled polypropylene
QTP	Food-grade polypropylene
QTPE	Polyester

### B / Filter media

Code	Description
P0	Polypropylene felt
POT	Thick polypropylene felt
PEF	Polyester felt
PEFT	Thick polyester felt

### C / Removal ratings - Nominal filtration efficiency

Code	Porosity	Materials			
		P0	POT	PEF	PEFT
1	1 µm	•	•	•	•
5	5 µm	•	•	•	•
10	10 µm	•	•	•	•
25	25 µm	•	•	•	•
50	50 µm	•	•	•	•
100	100 µm	•	•	•	•
200	200 µm	•		•	

### D / Sizes

Code	Description	Filter surface
10	Size 10 (290 mm)	0,7 m <sup>2</sup>
20	Size 20 (530 mm)	1,3 m <sup>2</sup>
20+	Size 20+ (700mm)	2 m <sup>2</sup>

### E / Seal materials

Code	Description
N	NBR
E	EPDM
F	FPM
EA	EPDM FDA

### Typical flow rates :

Pressure drops for filtration media only

Pressure losses (mBar)

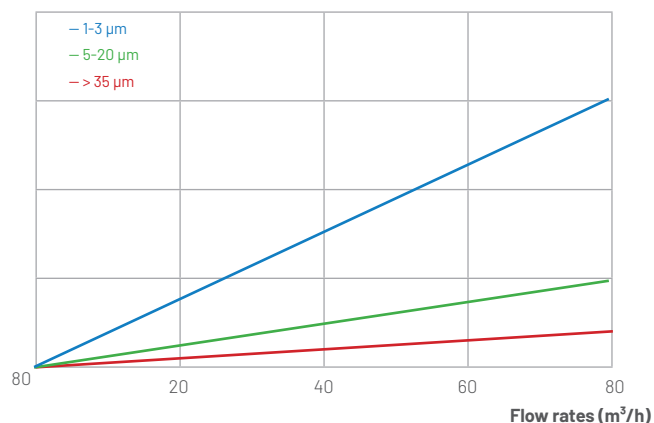

60

Pressure drops for a size 20 pleated filter bag<sup>2</sup>

Pressure losses (mBar)

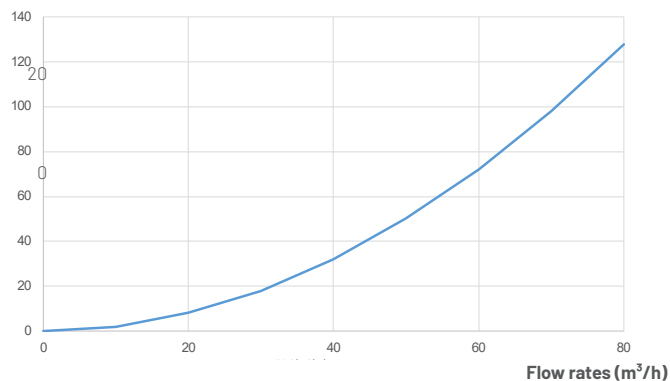

<sup>2</sup> Typical initial pressure drop  $\Delta P$  per 40" element, water at 20°C, viscosity 1cP.

# QUALI-PLEATED-BAG-FELT

PLEATED FELT FILTER BAG



## MAGNETIC ROD VERSION

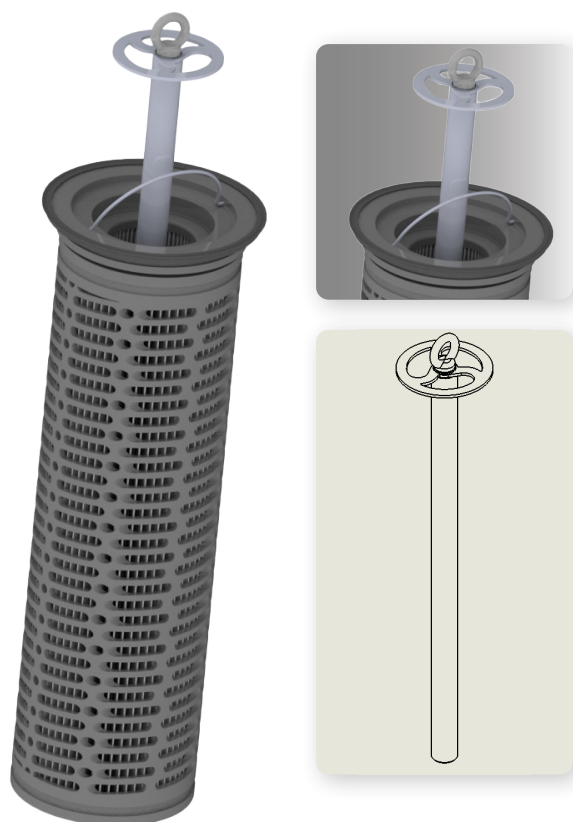

### Description

A special version has been designed to integrate a magnetic rod (3800 Gauss or 11000 Gauss).

The magnetic rod helps extend the lifetime of the QUALI-PLEATED-BAG-HE100 thanks to magnetic pre-filtration.

The magnetic holder fits directly into the QUALI-PLEATED-BAG and can be reused each time.

A removable handle is added to the pleated bag to facilitate handling.

### Magnetic rod references

Model	Size	Standard version	Standard version + scraper
3800 Gauss cartridge	T20/T20+/T21	QTP-P-MAG-20	QTP-P-MAG-20-RCL
11000 Gauss cartridge	T20/T20+/T21	QTP-P-MAG-HD-20	QTP-P-MAG-HD-20-RCL

### ORDER REFERENCE

Order reference for the quali-pleated-bag for insertion of magnetic bars :

Add the code HX at the end of the reference.

Example :

QTPR - P - PP - 10 - 20 - 0 - N - HX

