

**Flowrate**58 m<sup>3</sup>/h**Total Head**

46.5 m

**Power**

7500 W

Horizontal mechanical seals pump  
for the transfer of corrosive fluids

**APPLICATIONS**

Corrosive fluids  
Dense fluids  
Bath transfer

**ADVANTAGES**

Great efficiency  
Acid and alkali resistant  
Galvanic bath transfer

**CONNECTION**

Union nut  
Threaded  
Grooved nozzle  
Flanges

**SPECIFICATION****Hydraulic performances**

Max flow rate (m <sup>3</sup> /h)	58
Total head (m)	46.5
Max temperature (°C)	80
Density	<1

**Motor**

Standard	IE3
Power supply (V)	230/400 Three-phase
Power (W)	7500
Frequency (Hz)	50 - 60
Rotation speed (tr/min)	3000 - 3600

**Design**

Technology	Mechanical seals
Available materials	Ebonite coated cast iron
Seals	carbide/carbide (other on request)
Gaskets	EPDM (PP) FPM (PP)



SIEBEC SAS  
contact@siebec.com



SIEBEC Ltd  
sales@siebec.co.uk



SIEBEC S.L.  
ventas@siebec.com



SIEBEC SRL  
commerciale@siebec.com



SIEBEC GmbH  
info@siebec.de



SIEBEC LDA  
info.pt@siebec.com

We are here to help.  
**Contact us!**



## DIMENSIONS

Units : mm

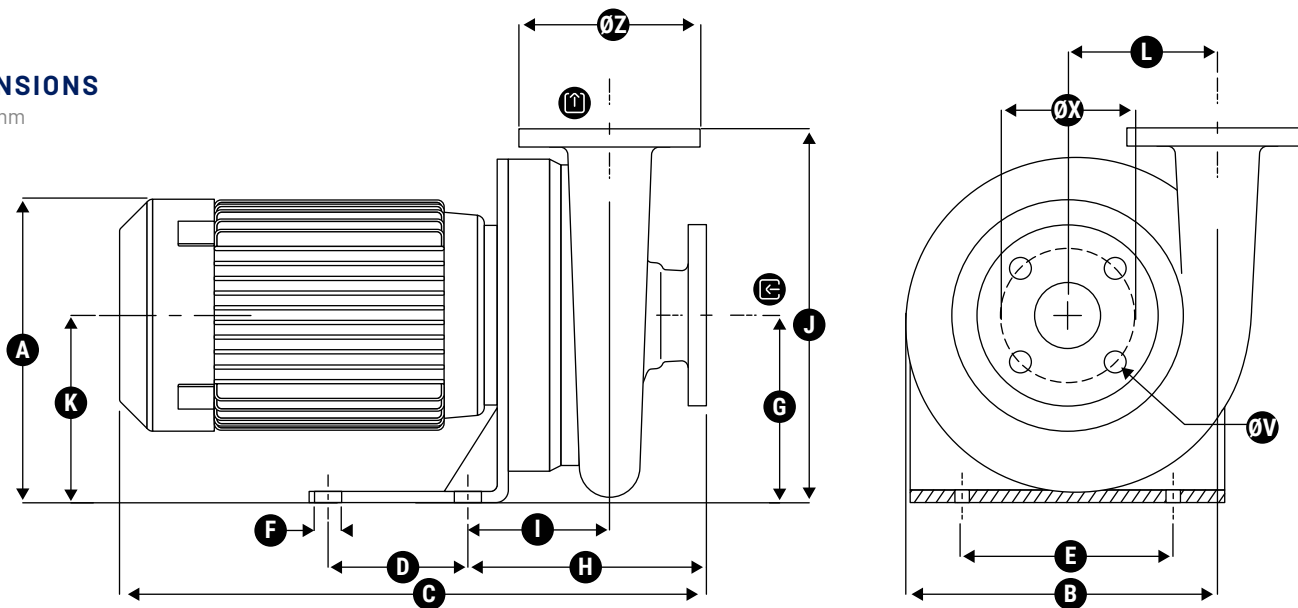

Outline dimensions			Fixation			Inlet / Outlet					
A	B	C	D	E	F	G	H	I	J	K	L
267	260	500	130	175	Ø12 (x4)	155	202	122	310	155	129

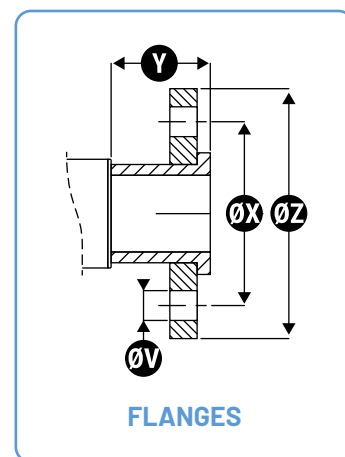
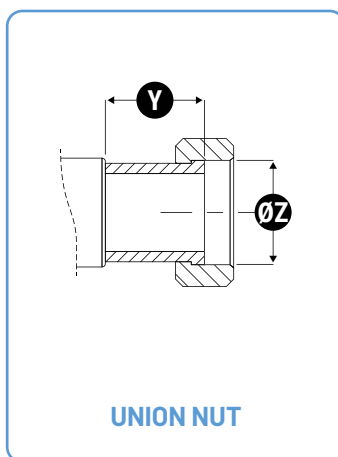
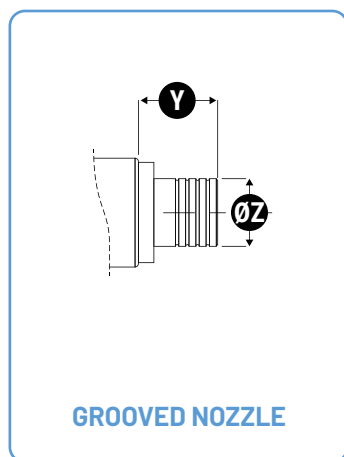

	Grooved nozzle		Union nut		Flanges			
	Y	Z	Y	Z	Y	Z	X	V
Entrée	-	-	-	-	-	150	110	Ø18
Sortie	-	-	-	-	-	150	110	Ø18

FT-SI-A-SERIES-A32-EN



## FLOWRATE CHARTS

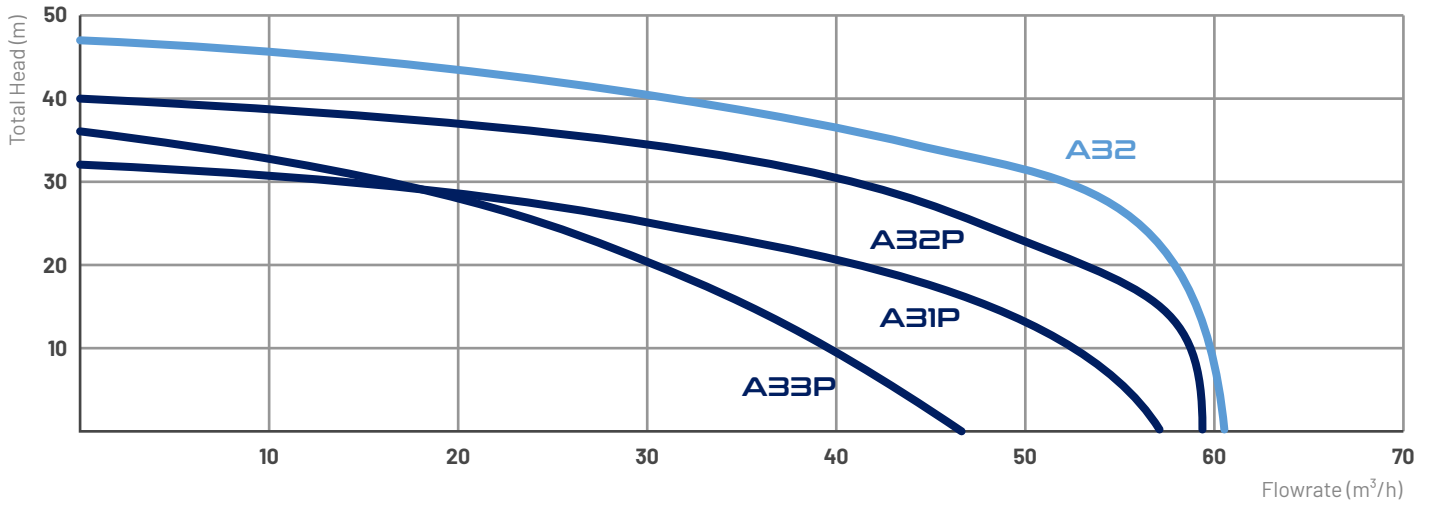

## NPSH CHART

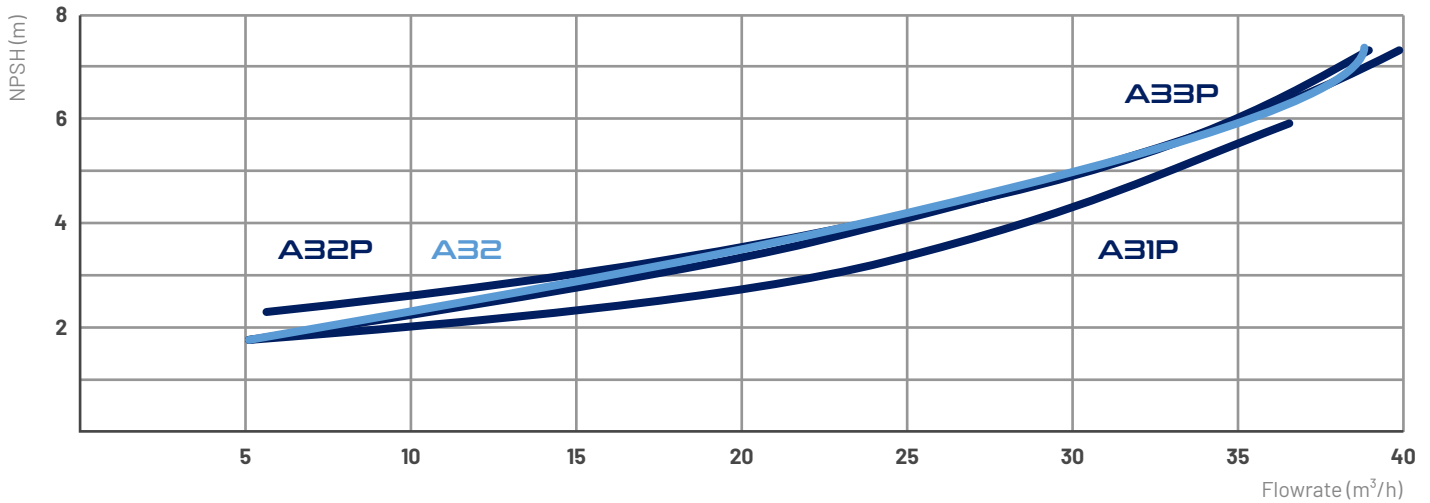

## EFFICIENCY CHART

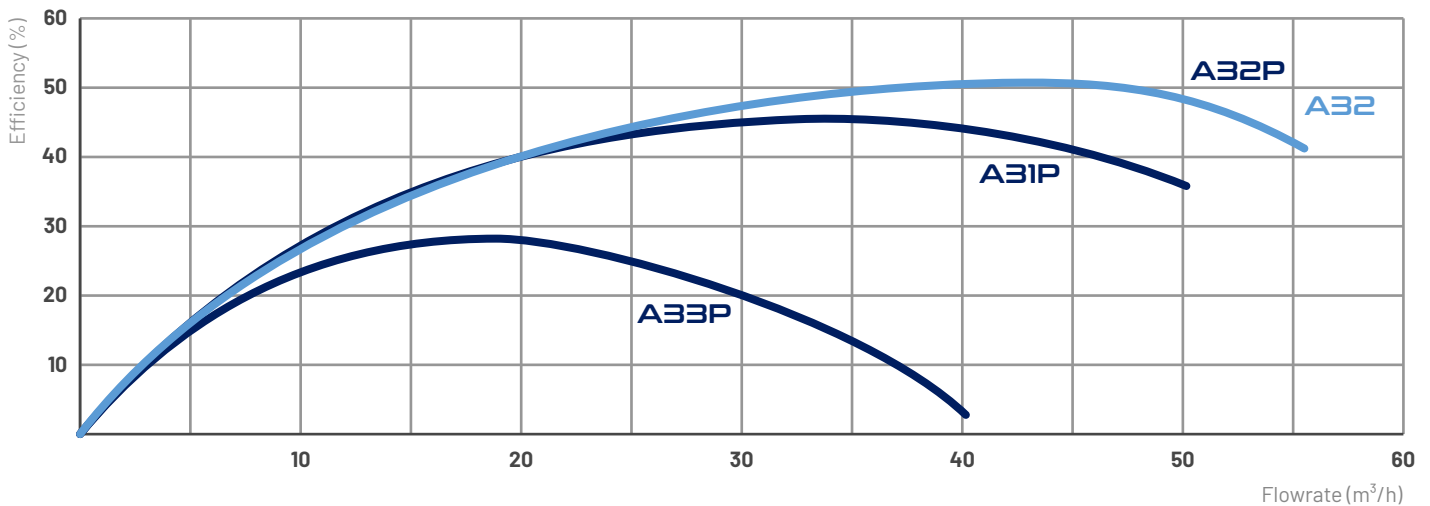

FT-SI-A-SERIES-A32-EN



## MECHANICAL SEALS SIEBEC PUMPS

## A SERIES

## CORROSIVE LIQUID-COMPATIBLE MODELS



	Flowrate (m <sup>3</sup> /h)	Total Head (m)	Power (W)	Density	Power supply (V)
A15	4,8	9	180	< 1.2	230/400 Three-phase
A18	10	18	750	< 1.8	230/400 Three-phase
A19	14	19	1100	< 1.7	230/400 Three-phase
A27	31,5	22	2200	< 1.4	230/400 Three-phase
A30	43	22	4000	< 1.6	230/400 Three-phase
A31P	52	32	5500 (7500*)	< 1,1 (<1,5*)	230/400 Three-phase
A32P	57	41	7500	< 1	230/400 Three-phase
A33P	48	36	5500	< 1,25	230/400 Three-phase
A32	58	46,5	7500	< 1	230/400 Three-phase

\*High Density version

**⚠ WARNING**  
NON-COMPATIBLE MODELS FOR CORROSIVE LIQUIDS



	Flowrate (m <sup>3</sup> /h)	Total Head (m)	Power (W)	Viscosity	Power supply (V)
AP18	10	16	550	15 cSt	230 Single-phase or 230/400 Three-phase
AP19	12.5	17,5	1100	15 cSt	230 Single-phase or 230/400 Three-phase
AP18HP	7,5	24	1100 (de 1 cSt à 45 cSt)	45 cSt	230 Single-phase or 230/400 Three-phase
AP19HP	10	30	1100 pour de l'eau 1500 pour de l'huile jusqu'à 45 cSt	45 cSt	230 Single-phase or 230/400 Three-phase

SIEBEC SAS  
contact@siebec.comSIEBEC Ltd  
sales@siebec.co.ukSIEBEC S.L.  
ventas@siebec.comSIEBEC SRL  
commerciale@siebec.comSIEBEC GmbH  
info@siebec.deSIEBEC LDA  
info.pt@siebec.comWe are here to help.  
**Contact us!**