**Flowrate**3 m<sup>3</sup>/h**Total Head**

7 m

**Power**

0.12 kW

Horizontal magnetic drive pump for the transfer of corrosiv fluids

**APPLICATIONS**

Corrosiv fluids  
Dense fluids  
Bath transfer

**ADVANTAGES**

Great efficiency  
Acid and alkali resistant  
Galavanic bath transfer

**CONNECTION**

Union nut  
Grooved nozzle  
Flanges

**SPECIFICATION****Hydraulic performances**

Max flow rate (m <sup>3</sup> /h)	3
Total head (m)	7
Max temperature (°C)	80 (PP)
Density	< 1.1

**Motor**

Standard	N/A
Power supply (V)	230 1ph
Frequency (Hz)	50 - 60
Rotation speed (rpm)	3000
Power (kW)	0.12

**Design**

Technology	Entrainement magnétique
Available materials	Polypropylène (PP)
Seals	Ceramic / ceramic or graphite / ceramic
Gaskets	EPDM (PP) FPM (PP - PVDF)

## DIMENSIONS

Units : (mm)

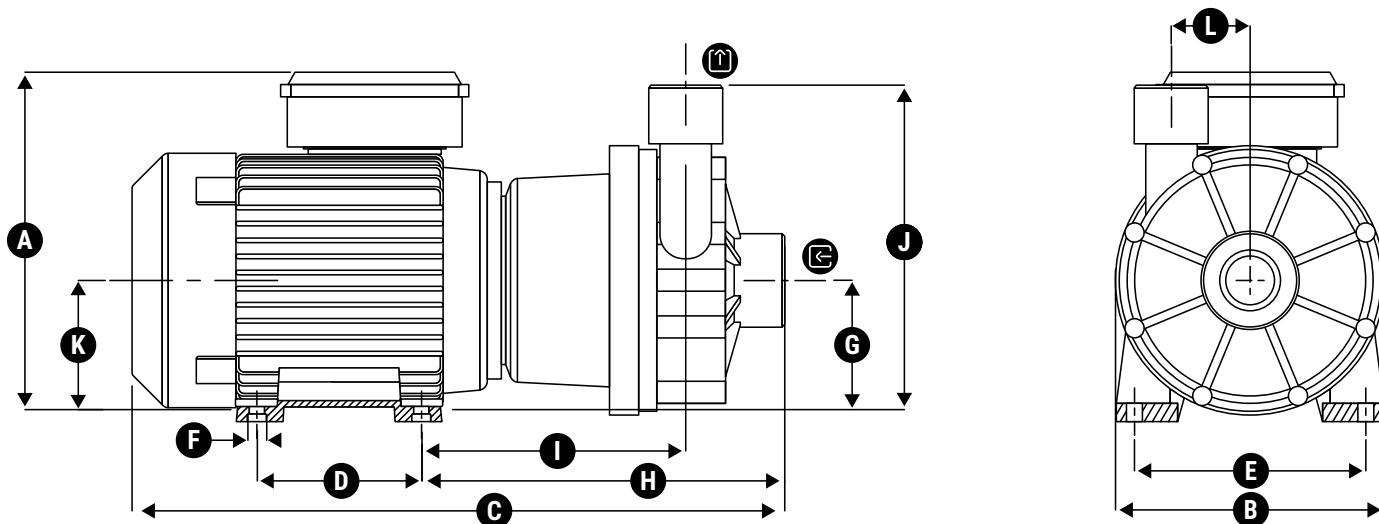

Outline dimensions			Fixation			Inlet / Outlet					
A	B	C	D	E	F	G	H	I	J	K	L
163	154.5	265.75	90	0	Ø6(x4)	56	145.75	105.5	163	56	N/A

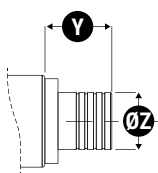

UNION NUT

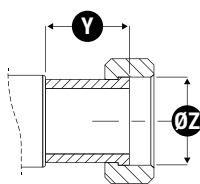

GROOVED NOZZLE

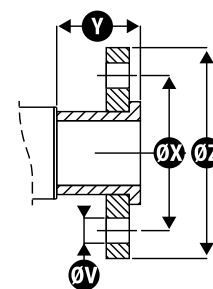

FLANGES

	Grooved nozzle		Union nut		Flanges			
	Y	Z	Y	Z	Y	Z	X	V
Entrée	35	Ø25	40	G1"1/4 DN20	40	Ø100 - DN20	Ø 75	4 x Ø12,5
Sortie	50	Ø25	55	G1" - DN15	55	Ø195 - DN15	Ø 65	Ø14 (x4)

## FLOWRATE CHARTS

Total Head (m)

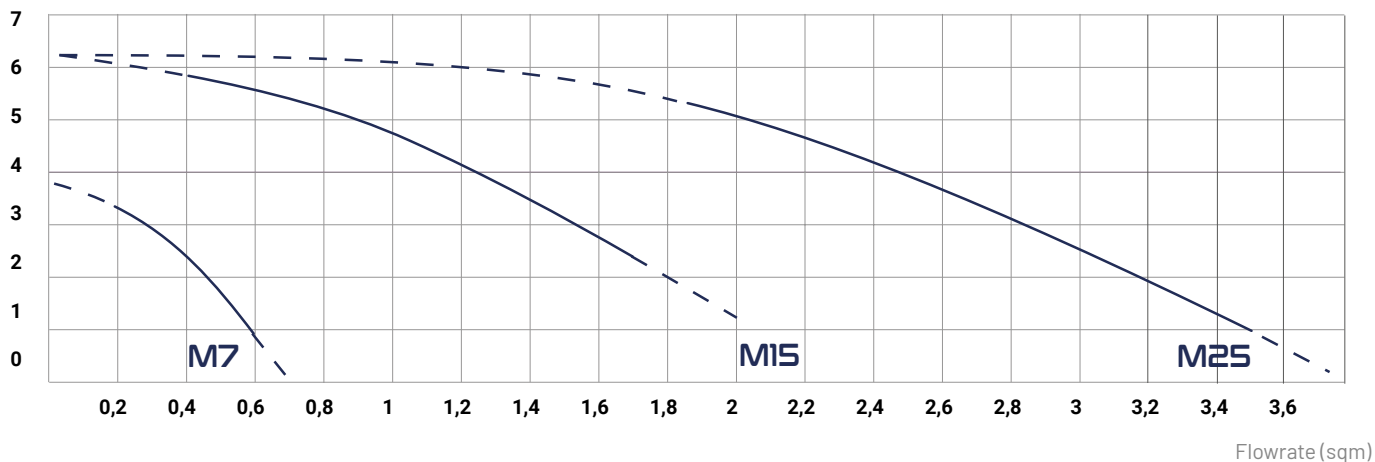

## NPSH CHART

NPSH (m)

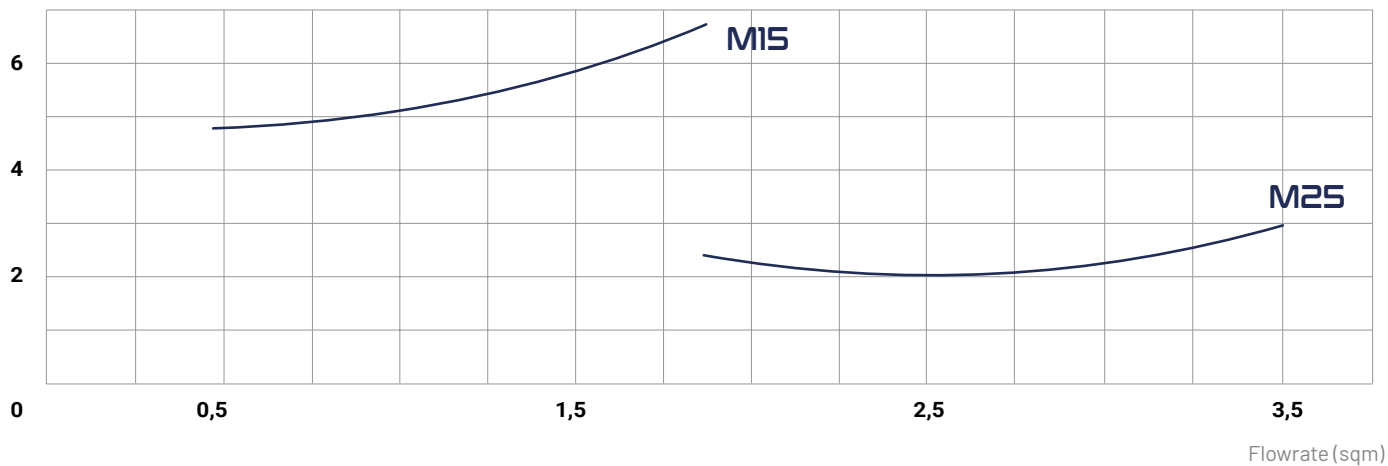

## SIEBEC MAGNETIC DRIVE PUMPS

		Flowrate (m <sup>3</sup> /h)	Total Head (m)	Power (kW)	Density	Power supply (V)
<b>M7</b>	Magnetic drive pump	0.7	4	0.01	1.2	230 1ph
<b>M15</b>	Magnetic drive pump	2	6	0.045	1.2	230 1ph
<b>M25</b>	Magnetic drive pump	3	7	0.12	1.1	230 1ph
<b>M35</b>	Magnetic drive pump	3	10	0.18	1.4	230 1ph
<b>M50</b>	Magnetic drive pump	5	10	0.18	1.2	230 1ph
<b>M70</b>	Magnetic drive pump	7	9.5	0.25	1.2	230 1ph
<b>M100</b>	Magnetic drive pump	10	18	0.75	1.5	230 / 400 3ph
<b>M140</b>	Magnetic drive pump	16	19	1.1	1.5	230 / 400 3ph
<b>M200</b>	Magnetic drive pump	21	20	1.1	1.5	230 / 400 3ph
<b>M250</b>	Magnetic drive pump	26	19	1.5	1.2	230 / 400 3ph
<b>M290</b>	Magnetic drive pump	31.5	21.5	2.2	1.5	230 / 400 3ph
<b>M390</b>	Magnetic drive pump	43	22	3	1.3	230 / 400 3ph